

MANNERS

RESIDENTIAL

2 Bedroom Flat for Rent - £1,000 per month
Jarman Court, Maybury Road, Woking, Surrey, GU21 5JD



KEY FEATURES

- WALKING DISTANCE TO STATION • TWO BEDROOMS & TWO BATHROOMS • GOOD SIZED LIVING ROOM • OPEN PLAN KITCHEN WITH APPLIANCES • GOOD NEUTRAL DECOR AND CARPETS • GAS CH & DOUBLE GLAZING • ONE ALLOCATED PARKING SPACE • UNFURNISHED • FIVE WEEK TENANCY DEPOSIT REQUIRED • EPC RATING:- B81

Description

Located in a sought after and highly convenient central position, within a short level walk of Woking town centre and mainline station, this first floor two bedroom, two bathroom apartment is decorated in neutral tones, and forms part of small development with allocated parking to the rear.

The accommodation comprises: communal entrance hall, private entrance hall, good sized living room with modern open plan kitchen with appliances including dishwasher, master bedroom with built in wardrobes and en-suite shower room, further good sized bedroom, modern bathroom, gas central heating, double glazing, allocated parking space.

Maximum Occupancy - 1 Household 4 Persons.

Additional Information: These particulars are meant as a guide only, and as such do not form part of a legally binding contract. Rent excludes the tenancy deposit of five weeks' rent up to an annual rent of £50,000 (£4166.67 pcm) and six weeks' rent above an annual rent of £50,000. A holding deposit of one weeks' rent is required upon making an Application For Tenancy which can be put towards the first month's rent, which will become payable upon signing the tenancy agreement. Should your Landlord accept a request to keep pets at the property, an additional monthly rent payment may be required. Upon request, further written information will be provided by the Agent.

These particulars are thought to be materially correct though their accuracy is not guaranteed and they do not form part of any contract. All measurements are approximate and we have not tested any appliances, electrical or plumbing installation or central heating systems.

Energy Efficiency Rating			
Score	Energy rating	Current	Potential
92+	A		
81-91	B	81 B	82 B
69-80	C		
55-68	D		
39-54	E		
21-38	F		
1-20	G		

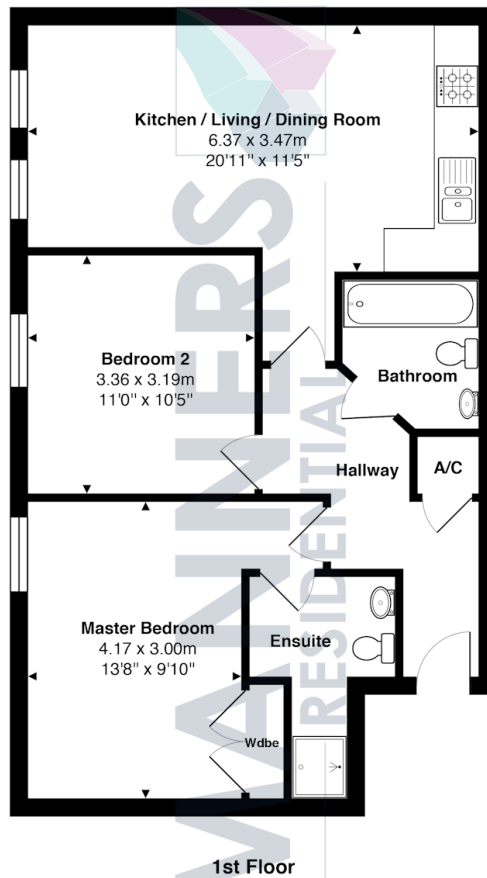

All measurements are approximate and for display purposes only. Not to scale.