

# MANNERS

## RESIDENTIAL

1 Bedroom Flat for Rent - £975 per month  
Katana, Brooklyn Road, Woking, Surrey, GU22 7TN



### KEY FEATURES

- TOP FLOOR APARTMENT • LARGE DOUBLE ASPECT LIVING ROOM • SPACIOUS DOUBLE BEDROOM • KITCHEN/BREAKFAST ROOM • MODERN BATHROOM WITH WINDOW • GAS HEATING • RESIDENTS PARKING • UNFURNISHED • FIVE WEEK TENANCY DEPOSIT REQUIRED • EPC RATING:- C73

## Description

An exceptionally large and neutrally decorated one bedroom top floor flat forming part of this exclusive small development in one of Woking's most prestigious residential areas within walking distance of the town centre and mainline station.

The accommodation which is presented in neutral tones throughout comprises, communal entrance hall with security entry phone system, large private entrance hall, spacious double aspect living room, modern fitted kitchen/breakfast room with appliances, huge bedroom with built in wardrobe, double glazing, gas fired central heating, allocated parking.

**Additional Information:** These particulars are meant as a guide only, and as such do not form part of a legally binding contract. Rent excludes the tenancy deposit of five weeks' rent up to an annual rent of £50,000 (£4166.67 pcm) and six weeks' rent above an annual rent of £50,000. A holding deposit of one weeks rent is required upon making an Application For Tenancy which can be put towards the first month's rent, which will become payable upon signing the tenancy agreement. Should your Landlord accept a request to keep pets at the property, an additional monthly rent payment may be required. Upon request, further written information will be provided by the Agent.

These particulars are thought to be materially correct though their accuracy is not guaranteed and they do not form part of any contract. All measurements are approximate and we have not tested any appliances, electrical or plumbing installation or central heating systems.

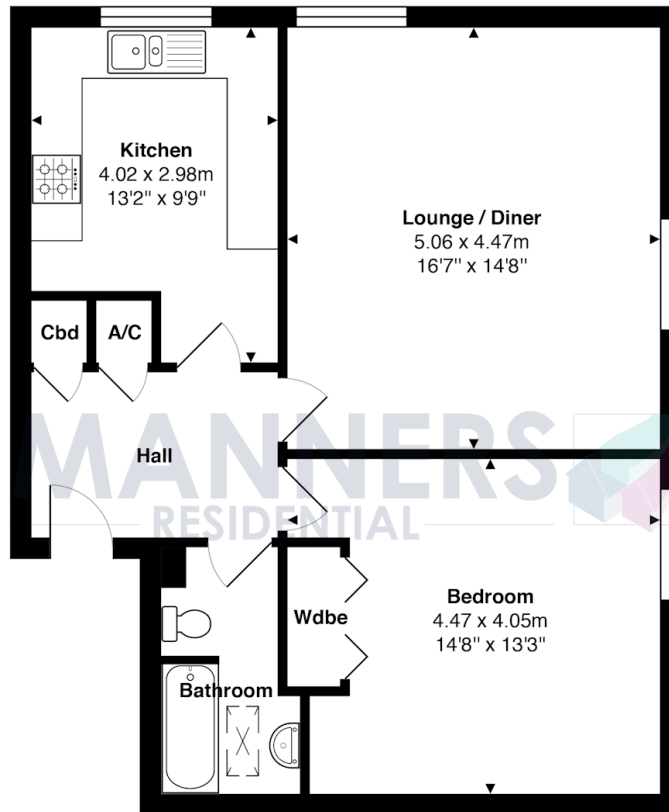
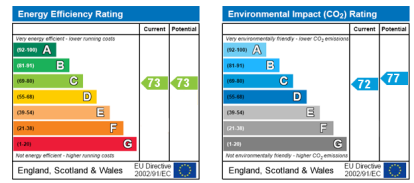

### 2nd Floor

Approx. Gross Internal Area 64.8 m<sup>2</sup> ... 698 ft<sup>2</sup>

All measurements are approximate and for display purposes only. Not to scale.