

MANNERS

RESIDENTIAL

2 Bedroom Flat for Rent - £975 per month
Alexandra Gardens, Knaphill, Woking, Surrey, GU21 2DL



KEY FEATURES

- 1ST FLOOR FLAT • LARGE LOUNGE WITH JULIET BALCONY • KITCHEN WITH APPLIANCES • MASTER BEDROOM WITH EN SUITE • FURTHER SECOND BEDROOM • WHITE BATHROOM SUITE WITH SHOWER • RESIDENTS PARKING & COMMUNAL GARDENS • UNFURNISHED • FIVE WEEK TENANCY DEPOSIT REQUIRED • EPC RATING:- C76

Description

This light & airy first floor two double bedroom flat offers spacious living accommodation and is presented in pristine order throughout. The property is located in a cul de sac position on a popular residential development approximately 10 minutes drive from Woking town centre and mainline station.

The accommodation comprises, communal entrance hall with security entry phone system, spacious private entrance hall, large lounge with juliet balcony, kitchen with appliances, master bedroom with en suite shower room, further second bedroom, white bathroom suite with shower, good neutral décor, residents parking and communal gardens.

Additional Information: These particulars are meant as a guide only, and as such do not form part of a legally binding contract. Rent excludes the tenancy deposit of five weeks' rent up to an annual rent of £50,000 (£4166.67 pcm) and six weeks' rent above an annual rent of £50,000. A holding deposit of one weeks rent is required upon making an Application For Tenancy which can be put towards the first month's rent, which will become payable upon signing the tenancy agreement. Should your Landlord accept a request to keep pets at the property, an additional monthly rent payment may be required. Upon request, further written information will be provided by the Agent.

These particulars are thought to be materially correct though their accuracy is not guaranteed and they do not form part of any contract. All measurements are approximate and we have not tested any appliances, electrical or plumbing installation or central heating systems.

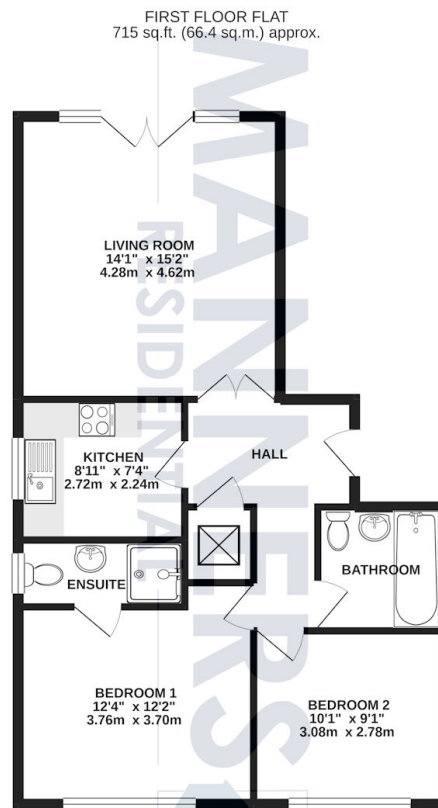
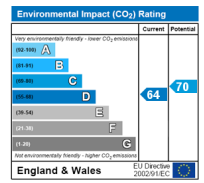
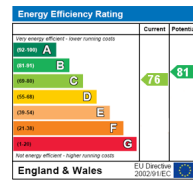

TOTAL FLOOR AREA: 715 sq.ft. (66.4 sq.m.) approx.

Whilst every attempt has been made to ensure the accuracy of the floorplan contained herein, measurements of doors, windows, rooms and any other items are approximate and no responsibility is taken for any error, omission or mis-statement. This plan is for illustration purposes only and should be used as such by any prospective purchaser. The services, systems and appliances shown have not been tested and no guarantee as to their operability or efficiency can be given.
Made with Mappers 1/2021