

MANNERS

RESIDENTIAL

1 Bedroom Flat for Rent - £925 per month

The Rowans, Montgomery Road, Woking, Surrey, GU22 7ST



KEY FEATURES

- GROUND FLOOR FLAT • SPACIOUS LOUNGE • MODERN FITTED KITCHEN • DOUBLE BEDROOM WITH WARDROBES • MODERN BATHROOM • ALLOCATED PARKING • NEUTRAL DÉCOR & CARPETS • UNFURNISHED • FIVE WEEK TENANCY DEPOSIT REQUIRED • EPC RATING:- C73

Description

Ground floor one bedroom flat, located within a short walk of Woking town centre and mainline station. The property features a modern refitted kitchen and bathroom, double bedroom with built in wardrobes, allocated parking and is neutrally decorated through out.

The accommodation comprises of communal entrance hall, private entrance hall with entry phone system, spacious lounge, modern kitchen, double bedroom, modern bathroom, allocated parking, neutral décor & carpets.

Additional Information: These particulars are meant as a guide only, and as such do not form part of a legally binding contract. Rent excludes the tenancy deposit of five weeks' rent up to an annual rent of £50,000 (£4166.67 pcm) and six weeks' rent above an annual rent of £50,000. A holding deposit of one weeks' rent is required upon making an Application For Tenancy which can be put towards the first month's rent, which will become payable upon signing the tenancy agreement. Should your Landlord accept a request to keep pets at the property, an additional monthly rent payment may be required. Upon request, further written information will be provided by the Agent.

These particulars are thought to be materially correct though their accuracy is not guaranteed and they do not form part of any contract. All measurements are approximate and we have not tested any appliances, electrical or plumbing installation or central heating systems.

Energy Efficiency Rating

Score	Energy rating	Current	Potential
92+	A		
81-91	B		
69-80	C	73 C	76 C
55-68	D		
39-54	E		
21-38	F		
1-20	G		

GROUND FLOOR
516 sq.ft. (47.9 sq.m.) approx.

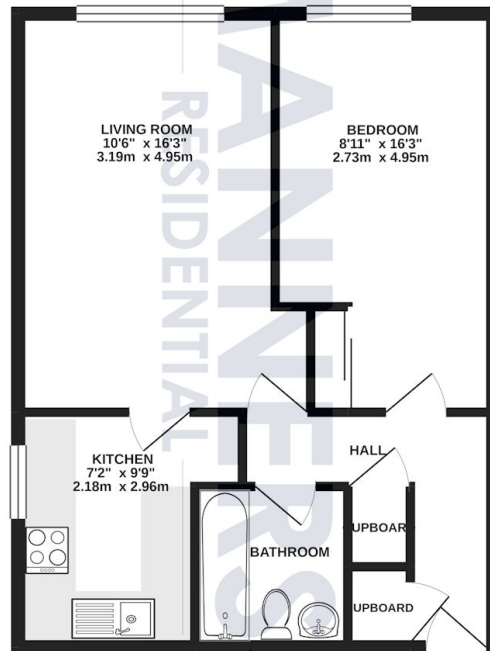

TOTAL FLOOR AREA: 516 sq.ft. (47.9 sq.m.) approx.

Whilst every attempt has been made to ensure the accuracy of the floorplan contained here, measurements of doors, windows, rooms and any other items are approximate and no responsibility is taken for any error, omission or mis-statement. This plan is for illustrative purposes only and should be used as such by any prospective purchaser. The services, systems and appliances shown have not been tested and no guarantee as to their operability or efficiency can be given.
Made with Metropix 1/2021