

MANNERS

RESIDENTIAL

1 Bedroom Flat for Rent - £900 per month

Ashdown Close, Guildford Road, Woking, Surrey, GU22 7PG



KEY FEATURES

- SHORT WALK TO WOKING TOWN CENTRE • HALLWAY WITH LAMINATE FLOORING • SPACIOUS LOUNGE
- FITTED KITCHEN WITH APPLIANCES • DOUBLE BEDROOM • MODERN BATHROOM SUITE WITH A SHOWER • RESIDENTS PARKING • UNFURNISHED • FIVE WEEK TENANCY DEPOSIT REQUIRED • EPC RATING:- D66

Description

A well presented one bedroom apartment set within a modern development which is located just a short walk to Woking town centre and mainline train station.

The accommodation comprises communal entrance hall with security entry phone system, private entrance hallway with laminate flooring, spacious lounge, modern fitted kitchen with appliances, double bedroom and modern bathroom suite with a shower. The property is decorated in neutral colours throughout and has parking.

This property is ideal for the professional commuter because Woking main line train station is within a few minutes walk and offers fast and regular services direct to Waterloo (about 30 mins). The town centre is next to the station and offers a comprehensive s...

Additional Information: These particulars are meant as a guide only, and as such do not form part of a legally binding contract. Rent excludes the tenancy deposit of five weeks' rent up to an annual rent of £50,000 (£4166.67 pcm) and six weeks' rent above an annual rent of £50,000. A holding deposit of one weeks' rent is required upon making an Application For Tenancy which can be put towards the first month's rent, which will become payable upon signing the tenancy agreement. Should your Landlord accept a request to keep pets at the property, an additional monthly rent payment may be required. Upon request, further written information will be provided by the Agent.

These particulars are thought to be materially correct though their accuracy is not guaranteed and they do not form part of any contract. All measurements are approximate and we have not tested any appliances, electrical or plumbing installation or central heating systems.

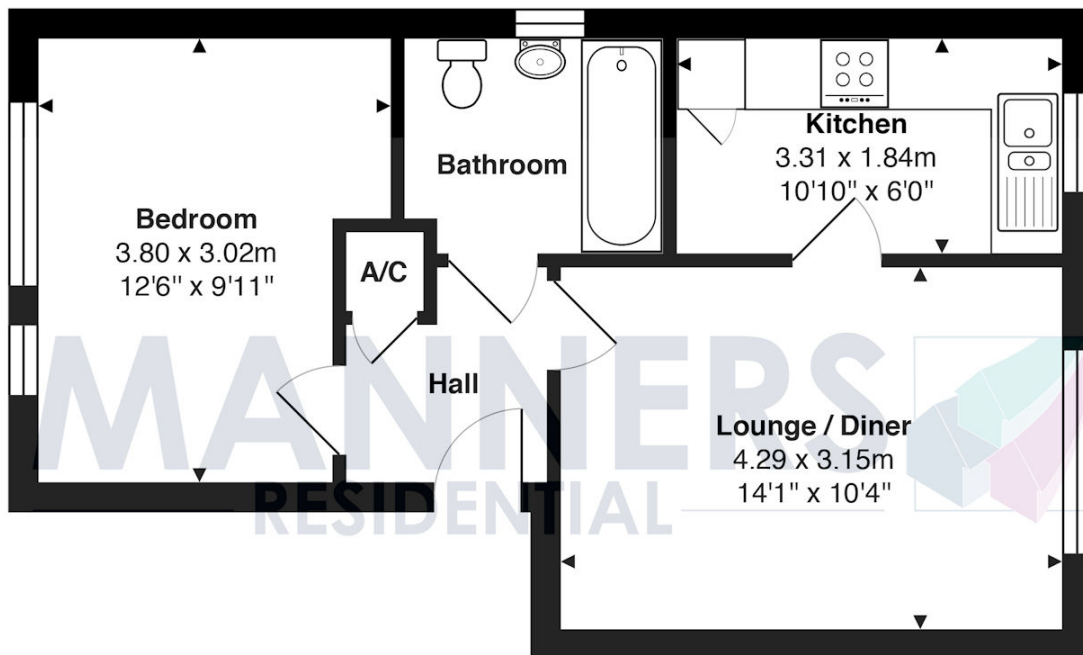
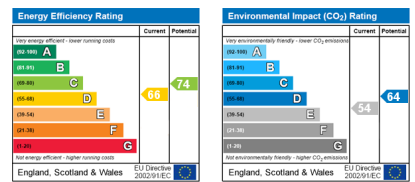

Ground Floor

Approx. Gross Internal Area 38.7 m² ... 416 ft²

All measurements are approximate and for display purposes only. Not to scale.