

MANNERS

RESIDENTIAL

3 Bedroom House for Sale - £400,000
Kinglake Court, St Johns, Woking, Surrey, GU21 8AL



KEY FEATURES

- END OF TERRACE HOUSE • LIVING ROOM • KITCHEN/BREAKFAST ROOM • THREE BEDROOMS • WHITE BATHROOM SUITE WITH SEPARATE W.C. • DOUBLE GLAZING & GAS HEATING • ENCLOSED REAR GARDEN • RESIDENTS PARKING • FREEHOLD • EPC RATING:- D63 / COUNCIL TAX BAND:- D

Description

This end of terraced home is presented in good order throughout and is located in a cul de sac position within walking distance of St Johns and Knaphill villages yet just a short drive or bus ride to Woking town centre.

The accommodation which is presented in neutral tones throughout comprises: entrance hallway, living room with patio doors to rear garden, refitted kitchen/breakfast room, stairs to first floor landing, three bedrooms, white bathroom suite with separate w.c., glazing, gas central heating, double glazing, enclosed rear garden.

Additional Information: These particulars are thought to be materially correct though their accuracy is not guaranteed and they do not form part of any contract. All measurements are approximate and we have not tested any appliances, electrical or plumbing installation or central heating systems.

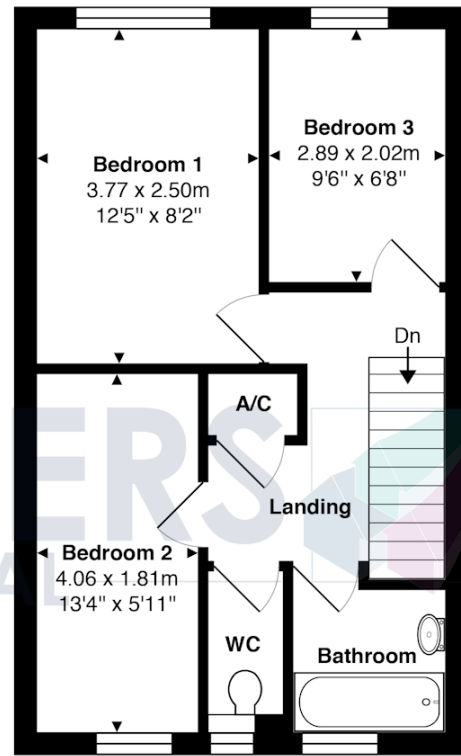
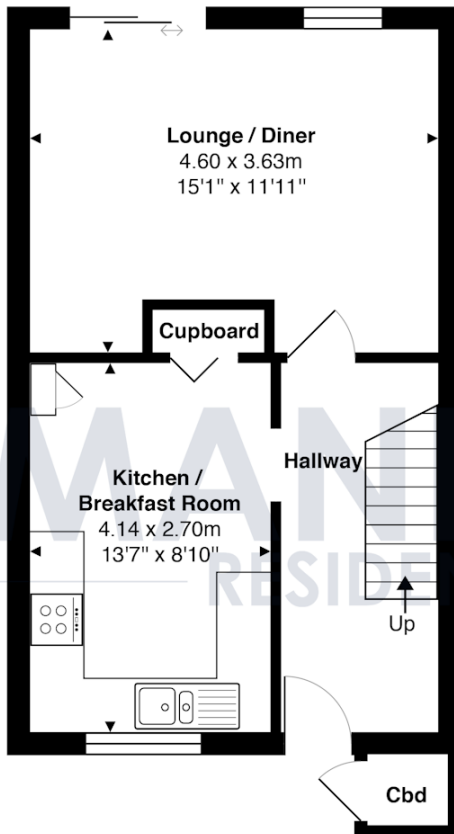
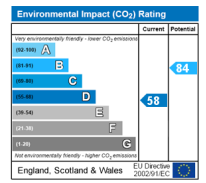
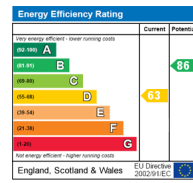

Ground Floor
 Approx. Gross Internal Area 37.1 m² ... 399 ft²

1st Floor
 Approx. Gross Internal Area 36.7 m² ... 395 ft²

Total Approx. Gross Internal Area 73.8 m² ... 794 ft²

All measurements are approximate and for display purposes only. Not to scale.

