

MANNERS

RESIDENTIAL

2 Bedroom Flat for Rent - £1,100 per month
Fircroft Court, Hillview Road, Woking, Surrey, GU22 7NA



KEY FEATURES

- FIRST FLOOR APARTMENT • SPACIOUS LIVING ROOM • MODERN KITCHEN • TWO DOUBLE BEDROOMS • MODERN BATHROOM • ELECTRIC HEATING & DOUBLE GLAZING • GARAGE IN A BLOCK • UNFURNISHED • FIVE WEEK TENANCY DEPOSIT • EPC RATING:- E44 / COUNCIL TAX BAND:-C

Description

This spacious two bedroom first floor apartment is being redecorated and re-carpeted, has a modern kitchen and bathroom and a garage, and is located in a highly convenient position within a short walk of the town centre and station.

The accommodation comprises: communal entrance hall, open plan private entrance area, spacious living room, modern kitchen, inner hallway, two double bedrooms, modern bathroom with shower, separate cloakroom, fresh neutral décor, new carpets to bedrooms, built in wardrobes, electric heating, double glazing, garage, very close to Woking Park and just a short walk to Woking town centre and mainline station.

Additional Information: These particulars are meant as a guide only, and as such do not form part of a legally binding contract. Rent excludes the tenancy deposit of five weeks' rent up to an annual rent of £50,000 (£4166.67 pcm) and six weeks' rent above an annual rent of £50,000. A holding deposit of one weeks' rent is required upon making an Application For Tenancy which can be put towards the first month's rent, which will become payable upon signing the tenancy agreement. Should your Landlord accept a request to keep pets at the property, an additional monthly rent payment may be required. Upon request, further written information will be provided by the Agent.

These particulars are thought to be materially correct though their accuracy is not guaranteed and they do not form part of any contract. All measurements are approximate and we have not tested any appliances, electrical or plumbing installation or central heating systems.

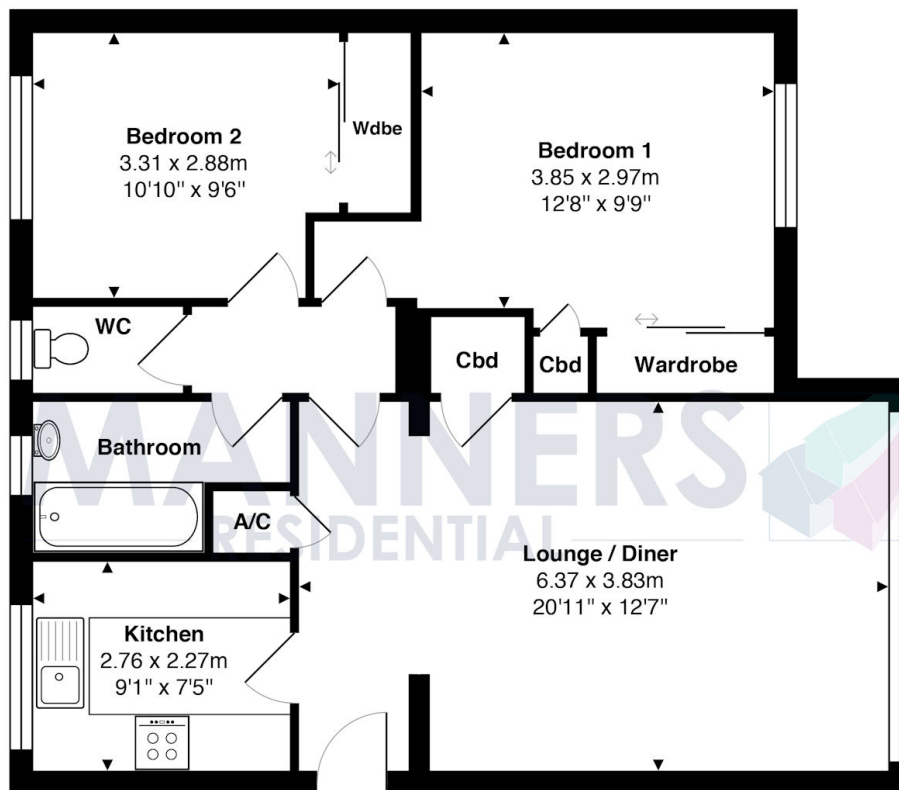
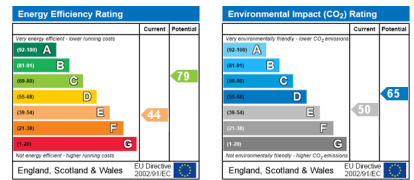

1st Floor

Total Approx. Gross Internal Area 68.4 m² ... 737 ft²

All measurements are approximate and for display purposes only. Not to scale.